

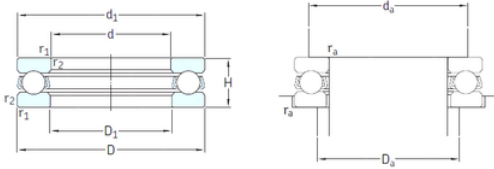

# BEARING DRIVESHAFT, INC.

## skf 51115 bearing

Bearing No. 51115



51115 Bearing 2D drawings and 3D CAD models

Size	75x100x19 mm
Bore Diameter	75 mm
Outer Diameter	100 mm
Width	19 mm
d	75 mm
D	100 mm
H	19 mm
d1	100 mm
r1 min.	1 mm
r2 min.	1 mm
D1	77 mm
da min.	90 mm
Da max.	85 mm
ra max.	1 mm
Weight	0,4 Kg
Basic dynamic load rating (C)	44,2 kN
Basic static load rating (C0)	134 kN
Fatigue load limit (Pu)	4,9
Reference speed	3200 r/min
Limiting speed	4300 r/min
Category	Thrust Ball Bearing
Inventory	0.0
Manufacturer Name	SKF
Minimum Buy Quantity	N/A
Weight / Kilogram	0.415
Product Group	B00308



## BEARING DRIVESHAFT, INC.

Rolling Element	Ball Bearing
Thrust Bearing	Yes
Single or Double Direction	Single Direction
Banded	No
Cage Material	Steel
Precision Class	ABEC 1   ISO P0
Component Description	Roller Assembly Plus Raceways
Other Features	Single Row
Long Description	75MM Bore 1; 77MM Bore 2; 100MM Outside Diameter; 19MM Height; Ball Bearing; Single Direction; Not Banded; Steel Cage; ABEC 1   ISO P0 Precision
Inch - Metric	Metric
Category	Thrust Ball Bearings
UNSPSC	31171507
Harmonized Tariff Code	8482.10.50.08
Noun	Bearing
Keyword String	Ball Thrust
Manufacturer URL	<a href="http://www.skf.com">http://www.skf.com</a>
Manufacturer Item Number	51115
Weight / LBS	0.913
Bore 1	2.953 Inch   75 Millimeter
Overall Height with Aligning Washer	0 Inch   0 Millimeter
Height	0.748 Inch   19 Millimeter
Bore 2	3.031 Inch   77 Millimeter
Outside Diameter	3.937 Inch   100 Millimeter
bore diameter:	75 mm
static load capacity:	134 kN
outside diameter:	100 mm



## BEARING DRIVESHAFT, INC.

dynamic load capacity:	44.2 kN
overall width:	19 mm
maximum rpm:	4300 RPM
thrust bearing type:	Single-Direction
cage material:	Steel
outside diameter design:	Straight
fillet radius:	1 mm
separable or banded:	Separable
series:	511
precision rating:	ABEC 1 (ISO Class Normal)
$d_1$	100 mm
$D_1$	77 mm
$r_{1,2}$ min.	1 mm
$d_a$ min.	90 mm
$D_a$ max.	85 mm
$r_a$ max.	1 mm
Basic dynamic load rating C	44.2 kN
Basic static load rating $C_0$	134 kN
Fatigue load limit $P_u$	4.9 kN
Minimum load factor A	0.11
Mass bearing (including seat washer where applicable)	0.4 kg