

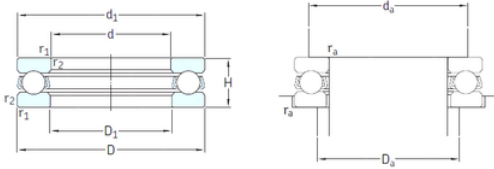

BEARING DRIVESHAFT, INC.

skf 51201 bearing

Bearing No. 51201



51201 Bearing 2D drawings and 3D CAD models

Size	12x28x11 mm
Bore Diameter	12 mm
Outer Diameter	28 mm
Width	11 mm
d	12 mm
D	28 mm
H	11 mm
d1	28 mm
r1 min.	0,6 mm
r2 min.	0,6 mm
D1	14 mm
da min.	22 mm
Da max.	18 mm
ra max.	0,6 mm
Weight	0,034 Kg
Basic dynamic load rating (C)	13,3 kN
Basic static load rating (C0)	20,8 kN
Fatigue load limit (Pu)	0,765
Reference speed	8000 r/min
Limiting speed	11000 r/min
Category	Thrust Ball Bearing
Inventory	0.0
Manufacturer Name	SKF
Minimum Buy Quantity	N/A
Weight / Kilogram	0.036
Product Group	B00308



BEARING DRIVESHAFT, INC.

Rolling Element	Ball Bearing
Thrust Bearing	Yes
Single or Double Direction	Single Direction
Banded	No
Cage Material	Steel
Precision Class	ABEC 1 ISO P0
Component Description	Roller Assembly Plus Raceways
Other Features	Single Row
Long Description	12MM Bore 1; 14MM Bore 2; 28MM Outside Diameter; 11MM Height; Ball Bearing; Single Direction; Not Banded; Steel Cage; ABEC 1 ISO P0 Precision
Inch - Metric	Metric
Category	Thrust Ball Bearings
UNSPSC	31171507
Harmonized Tariff Code	8482.10.50.08
Noun	Bearing
Keyword String	Ball Thrust
Manufacturer URL	http://www.skf.com
Manufacturer Item Number	51201
Weight / LBS	0.08
Height	0.433 Inch 11 Millimeter
Bore 1	0.472 Inch 12 Millimeter
Bore 2	0.551 Inch 14 Millimeter
Overall Height with Aligning Washer	0 Inch 0 Millimeter
Outside Diameter	1.102 Inch 28 Millimeter
bore diameter:	12 mm
static load capacity:	20.8 kN
outside diameter:	28 mm
dynamic load capacity:	13.3 kN



BEARING DRIVESHAFT, INC.

overall width:	11 mm
maximum rpm:	11000 RPM
thrust bearing type:	Single-Direction
cage material:	Steel
outside diameter design:	Straight
fillet radius:	0.6 mm
separable or banded:	Separable
series:	512
precision rating:	ABEC 1 (ISO Class Normal)
d_1	28 mm
D_1	14 mm
$r_{1,2}$ min.	0.6 mm
d_a min.	22 mm
D_a max.	18 mm
r_a max.	0.6 mm
Basic dynamic load rating C	13.3 kN
Basic static load rating C_0	20.8 kN
Fatigue load limit P_u	0.765 kN
Minimum load factor A	0.0022
Mass bearing (including seat washer where applicable)	0.034 kg