

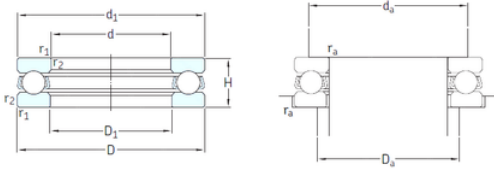

BEARING DRIVESHAFT, INC.

skf 51306 bearing

Bearing No. 51306



51306 Bearing 2D drawings and 3D CAD models

Size	30x60x21 mm
Bore Diameter	30 mm
Outer Diameter	60 mm
Width	21 mm
d	30 mm
D	60 mm
H	21 mm
d1	60 mm
r1 min.	1 mm
r2 min.	1 mm
D1	32 mm
da min.	48 mm
Da max.	42 mm
ra max.	1 mm
Weight	0,26 Kg
Basic dynamic load rating (C)	35,8 kN
Basic static load rating (C0)	65,5 kN
Fatigue load limit (Pu)	2,4
Reference speed	3800 r/min
Limiting speed	5300 r/min
Category	Thrust Ball Bearing
Inventory	0.0
Manufacturer Name	SKF
Minimum Buy Quantity	N/A
Weight / Kilogram	0.265
Product Group	B00308



BEARING DRIVESHAFT, INC.

Rolling Element	Ball Bearing
Thrust Bearing	Yes
Single or Double Direction	Single Direction
Banded	No
Cage Material	Steel
Precision Class	ABEC 1 ISO P0
Component Description	Roller Assembly Plus Raceways
Other Features	Single Row
Long Description	30MM Bore 1; 32MM Bore 2; 60MM Outside Diameter; 21MM Height; Ball Bearing; Single Direction; Not Banded; Steel Cage; ABEC 1 ISO P0 Precision
Inch - Metric	Metric
Category	Thrust Ball Bearings
UNSPSC	31171507
Harmonized Tariff Code	8482.10.50.08
Noun	Bearing
Keyword String	Ball Thrust
Manufacturer URL	http://www.skf.com
Manufacturer Item Number	51306
Weight / LBS	0.584
Overall Height with Aligning Washer	0 Inch 0 Millimeter
Bore 2	1.26 Inch 32 Millimeter
Height	0.827 Inch 21 Millimeter
Bore 1	1.181 Inch 30 Millimeter
Outside Diameter	2.362 Inch 60 Millimeter
bore diameter:	30 mm
static load capacity:	65.5 kN
outside diameter:	60 mm
dynamic load capacity:	35.8 kN



BEARING DRIVESHAFT, INC.

overall width:	21 mm
maximum rpm:	5300 RPM
thrust bearing type:	Single-Direction
cage material:	Steel
outside diameter design:	Straight
fillet radius:	1 mm
separable or banded:	Separable
series:	513
precision rating:	ABEC 1 (ISO Class Normal)
d_1	60 mm
D_1	32 mm
$r_{1,2}$ min.	1 mm
d_a min.	48 mm
D_a max.	42 mm
r_a max.	1 mm
Basic dynamic load rating C	35.8 kN
Basic static load rating C_0	65.5 kN
Fatigue load limit P_u	2.4 kN
Minimum load factor A	0.026
Mass bearing (including seat washer where applicable)	0.26 kg