

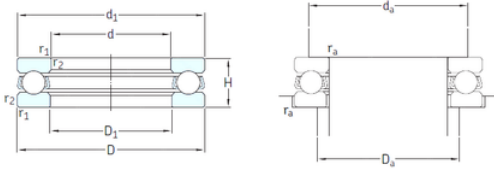

BEARING DRIVESHAFT, INC.

skf 51105 bearing

Bearing No. 51105



51105 Bearing 2D drawings and 3D CAD models

Size	25x42x11 mm
Bore Diameter	25 mm
Outer Diameter	42 mm
Width	11 mm
d	25 mm
D	42 mm
H	11 mm
d1	42 mm
r1 min.	0,6 mm
r2 min.	0,6 mm
D1	26 mm
da min.	35 mm
Da max.	32 mm
ra max.	0,6 mm
Weight	0,056 Kg
Basic dynamic load rating (C)	18,2 kN
Basic static load rating (C0)	39 kN
Fatigue load limit (Pu)	1,43
Reference speed	6300 r/min
Limiting speed	9000 r/min
Category	Thrust Ball Bearing
Inventory	4.0
Manufacturer Name	SKF
Minimum Buy Quantity	N/A
Weight / Kilogram	0.062
Product Group	B00308



BEARING DRIVESHAFT, INC.

Rolling Element	Ball Bearing
Thrust Bearing	Yes
Single or Double Direction	Single Direction
Banded	No
Cage Material	Steel
Precision Class	ABEC 1 ISO P0
Component Description	Roller Assembly Plus Raceways
Other Features	Single Row
Long Description	25MM Bore 1; 26MM Bore 2; 42MM Outside Diameter; 11MM Height; Ball Bearing; Single Direction; Not Banded; Steel Cage; ABEC 1 ISO P0 Precision
Inch - Metric	Metric
Category	Thrust Ball Bearings
UNSPSC	31171507
Harmonized Tariff Code	8482.10.50.08
Noun	Bearing
Keyword String	Ball Thrust
Manufacturer URL	http://www.skf.com
Manufacturer Item Number	51105
Weight / LBS	0.136
Bore 2	1.024 Inch 26 Millimeter
Outside Diameter	1.654 Inch 42 Millimeter
Bore 1	0.984 Inch 25 Millimeter
Overall Height with Aligning Washer	0 Inch 0 Millimeter
Height	0.433 Inch 11 Millimeter
bore diameter:	25 mm
static load capacity:	39 kN
outside diameter:	42 mm
dynamic load capacity:	18.2 kN



BEARING DRIVESHAFT, INC.

overall width:	11 mm
maximum rpm:	9000 RPM
thrust bearing type:	Single-Direction
cage material:	Steel
outside diameter design:	Straight
fillet radius:	0.6 mm
separable or banded:	Separable
series:	511
precision rating:	ABEC 1 (ISO Class Normal)
d_1	42 mm
D_1	26 mm
$r_{1,2}$ min.	0.6 mm
d_a min.	35 mm
D_a max.	32 mm
r_a max.	0.6 mm
Basic dynamic load rating C	18.2 kN
Basic static load rating C_0	39 kN
Fatigue load limit P_u	1.43 kN
Minimum load factor A	0.0079
Mass bearing (including seat washer where applicable)	0.056 kg